



Technical Data Sheet

Bibby Wavemaster Horizon

- Service operation vessel with walk to work gangway system
- Launched 2019



GENERAL

Yard number	553021
Delivery date	04 October 2019
Basic functions	To provide stepless access onto windfarm assets for technicians, tools and parts by access system, crane and daughter craft. Purpose-built for long-term O&M charter in North Sea offshore wind farms.
Classification	DNV 1A1 Offshore service vessel BIS BWM(T) Clean COMF(C-2, V-2) Crane DK(+) DYNPOS(AUTR) EO NAUT(OSV(A)) Recyclable SF SPS
Flag	UK MCA, SPS 2008 Code
Owner	Centrus Marine One Ltd
Charterer (long-term)	Siemens Gamesa Renewable Energy and EnBW

DIMENSIONS

Length overall	89.65 m
Beam moulded	20.00 m
Depth moulded	8.00 m
Draught base (u.s. keel)	4.80 (6.30) m
Gross Tonnage	6262 GT

CAPACITIES

Ballast water	1187 m ³ incl. roll reduction tank
Fuel oil (service + cargo)	541 + 351 m ³
Fr. water (potable + cargo)	184 + 436 m ³
Deadweight	2139 t at design draught 4.65m ²
Cargo weather deck area	425 m ²
Covered warehouse areas	390 m ² i (2 x 20ft cont.)
Max. deck load	600 t at max. 1 m ab. deck
Dangerous Goods	Helifuel in up to 3 transportable tanks. Packaged DG (not for trade) in paint/IMDG store and modular COSHH containers.

PERFORMANCES

Speed @ summer draught)	13.0 / 12.0 kn max / eco
ERN*	99,99, 97, 96
Endurance	30 days

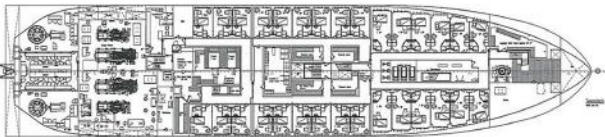
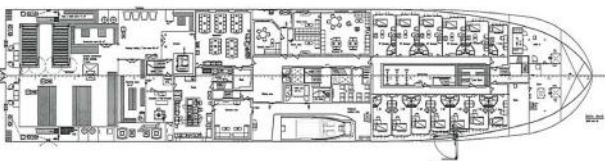
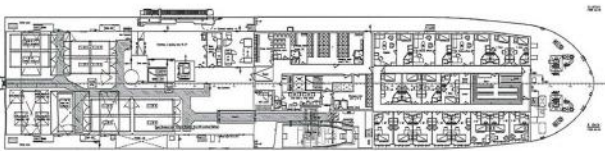
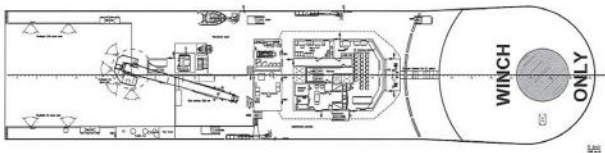
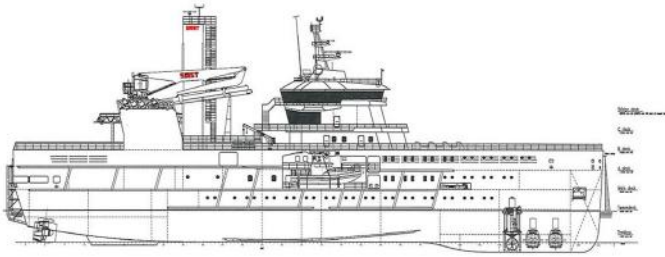

PROPULSION SYSTEM

Main engines	Diesel-electric, 690 V, 60 Hz
Propulsion power	2x azi thruster (ducted, FP) 21 SO kW
Bow thrusters	2x 860 kW fixed + 1x 860 kW retractable

ELECTRICAL EQUIPMENT

Networks	690 V, 440 V and 230 V - 60 Hz
Main generator sets	4 pcs. -total installed electric power 6434 kW
Power philosophy	4-split main busbar with 2-split low-load mode offering low FO burn, engine fouling and wear.

DECK LAY-OUT

Gangway access system	3D motion-compensated gangway SMST, height-adjustable stepless over 10m. Gangway operator station on the bridge.
Offshore crane	Offshore knuckle boom crane 2t, 3D motion compensated @ max. 25m outreach.
Lift	1 ton lift for continuous access for personnel and trolleys between warehouse, weather deck and WTG via gangway.
Daughter craft	Mare Safety 11m high-speed windfarm service boat for 10 technicians, 2 crew + 1t cargo. Operability up to 1.2m Hs.
Helicopter facilities	Winch-only area on foreship.
CTV landing facilities	1 fixed steel CTV landing structure at stern for transfer of technicians and cargo.
Lifesaving	Rescue boat and life rafts for total 60PAX Total 60 cabins for up to approx. 20 crew and up to approx. 40 SP, all in single cabins.

ACCOMMODATION

Crew/ special personnel	All cabins provided with WiFi, LAN, telephone and audio / video entertainment (Video-on-Demand and sat. TV).
Other facilities	4 Offices (10 desks) and 1 combined briefing room (25 seats) / conference area (10 seats) for Charterer's use. 2 Recr.-dayrooms, 2 game rooms, cinema, smoker's lounge, reception, hospital, drying room, changing rooms (M/F), large gym.

NAUTICAL AND COMMUNICATION EQUIPMENT

Nautical	Radar X-band + S-band, ECDIS, Conning, GMDSS Area I, 2 and 3.
DP-system	DP-2 with Laser, beaconless radar and 2xDGPS pos.ref.sys. Fitted with wind farm route planning tool and high-speed autotrack DP.
Communication	VSAT, 4G coverage, portable DECT-telephones in Charterer areas.

ENQUIRIES

enquiries@bibbymarine.com
www.bibbymarine.com

