

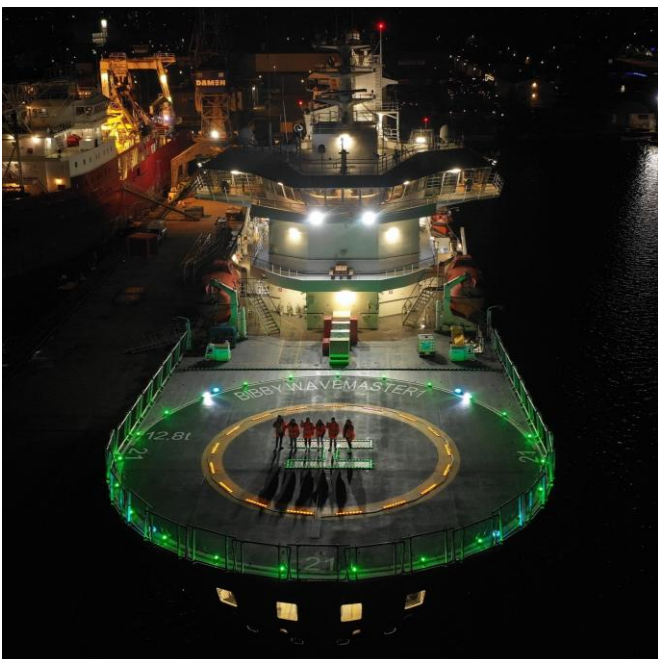

Technical Data Sheet

Bibby Wavemaster 1

- Service operation vessel with walk to work gangway system
- Launched 2017

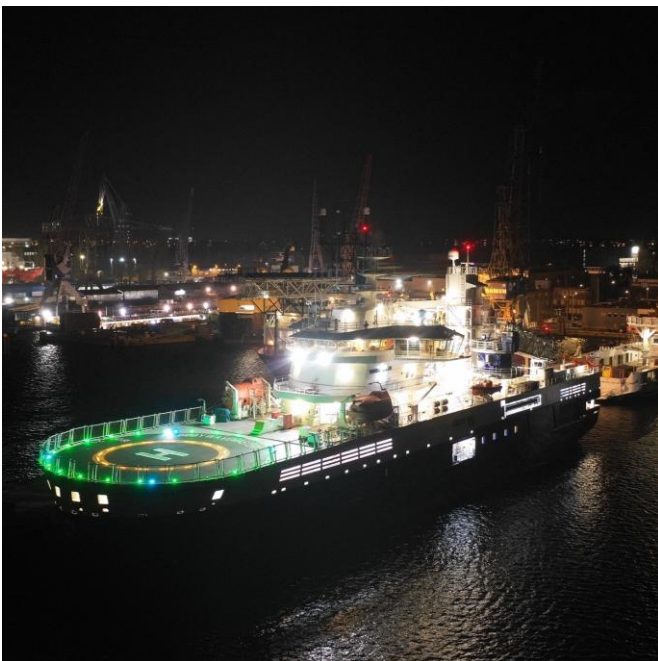

GENERAL

Yard number	553016
Delivery date	August 2017
Basic functions	Offshore transfers for special personnel and equipment by means of a motion compensated access system and heave compensated offshore rated crane on a stable DP-2 platform
Classification	DNV-GL Maritime, notation: 1A1, Offshore Service Vessel, COMF(C2, V-2), DYNPOS(AUTR), Clean, E0, SPS, NAUT(OSV(A)), BWM(T), Recyclable, BIS, HELDK, Crane, DK(+)
Flag	UK MCA, SPS 2008 Code
Owner	Bibby Wavemaster 1 Limited

DIMENSIONS

Length o.a.	89.65 m
Length loadline (IMO)	84.95 m
Beam mid.	20.00 m
Depth mid.	8.00 m
Draught summer (base / u.s. keel)	4.80 m / 6.30 max foreship
Deadweight at summer draught	2260 t
Cargo weather deck area	425 m ² (11 slots for 20ft cont.)
Covered / conditioned	390 m ²
Warehouse areas	(6 slots for 20ft containers, level floors)
Deck load (at 1m above deck)	600 t

TANK CAPACITIES (APPROX.)

Ballast water	1130 m ³
Fuel oil (service + cargo)	545 m ³ + 345 m ³
Fresh water (serv./potable + cargo)	180 m ³ + 430 m ³
Waste water (holding/black/grey)	129 m ³

PERFORMANCES

Speed (at summer draught)	13.0 kn
Economical speed	12.0 kn
ERN*	99,99,98,97

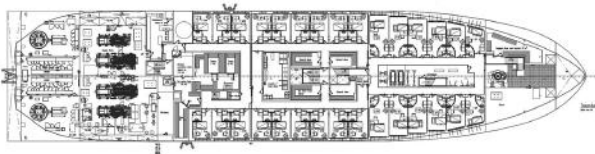
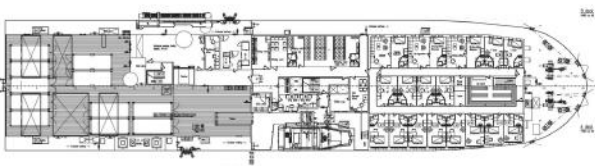
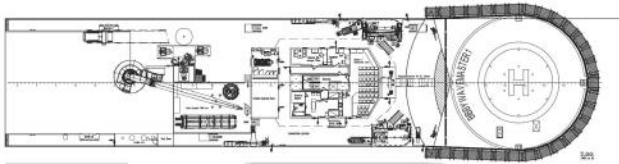
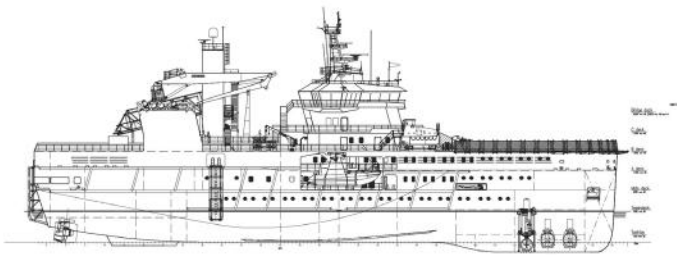

PROPULSION SYSTEM

Main engines	Diesel-electric, 690 V, 60 Hz
Propulsion power	2x elec. motors of approx. 2150 kW each
Azimuthing thrusters	2x FP propellers in nozzles
Bow thrusters	2x 860 kW fixed + 1x 860 kW retractable

AUXILIARY EQUIPMENT

Networks	690 V, 440 V and 230 V - 60 Hz
Main generator sets	4 pcs. - total installed electric power 6452 ekW
Emerg. generator set	1 pcs. - 238 ekW

DECK LAY-OUT

Offshore crane	Knuckle boom crane 2t AHC / 5t max SWL.
Access system	Continuous access from warehouses to WTS/OSS provided by 6 station multi stop elevator and linked Uptime W2W 3D motion compensated gangway with height adjustable pedestal.
Daughter craft vessel	Tuco Marine Pro zero 11m windfarm service boat.
Helicopter deck capacity CTV landing facilities	D-factor 21 m, take-off weight 12.8 tonnes. 1 fixed steel landing structure at stern. CTV refuelling station at SB side.
Anchor mooring winch	Foredeck: 2x electric/hydraulic, with rope drum and warping head. Aft deck: 2x capstan St pull each.

LIFE SAVING EQUIPMENT

Lifeboats	2 x 45 persons
Liferafts	Numbers as per regulations

ACCOMMODATION

Crew / special personnel	Total 90 persons on board. 60 single or large double cabins for crew and Special Personnel provided with internet, telephone and video entertainment (VOD and satellite TV).
Other spaces	5 offices, 3 meeting/conference rooms for Charterer's use. 2 recreation-dayrooms, reception room, hospital, 2 drying rooms, changing rooms (M/F), wellness area (gym and sauna).

NAUTICAL AND COMMUNICATION EQUIPMENT

Nautical	Radar X-band + S-band, ECDIS, Conning, GMDSS Area I, 2 and 3
DP - system	DP-2 with Radar (Radius), Laser (Spottrack) and 2 x DGPS reference systems. 3 x gyro-compass.

ENQUIRIES

enquiries@bibbymarine.com
www.bibbymarine.com

